

# Clock Function

Figure 1

Press this icon to enter the Clock Function

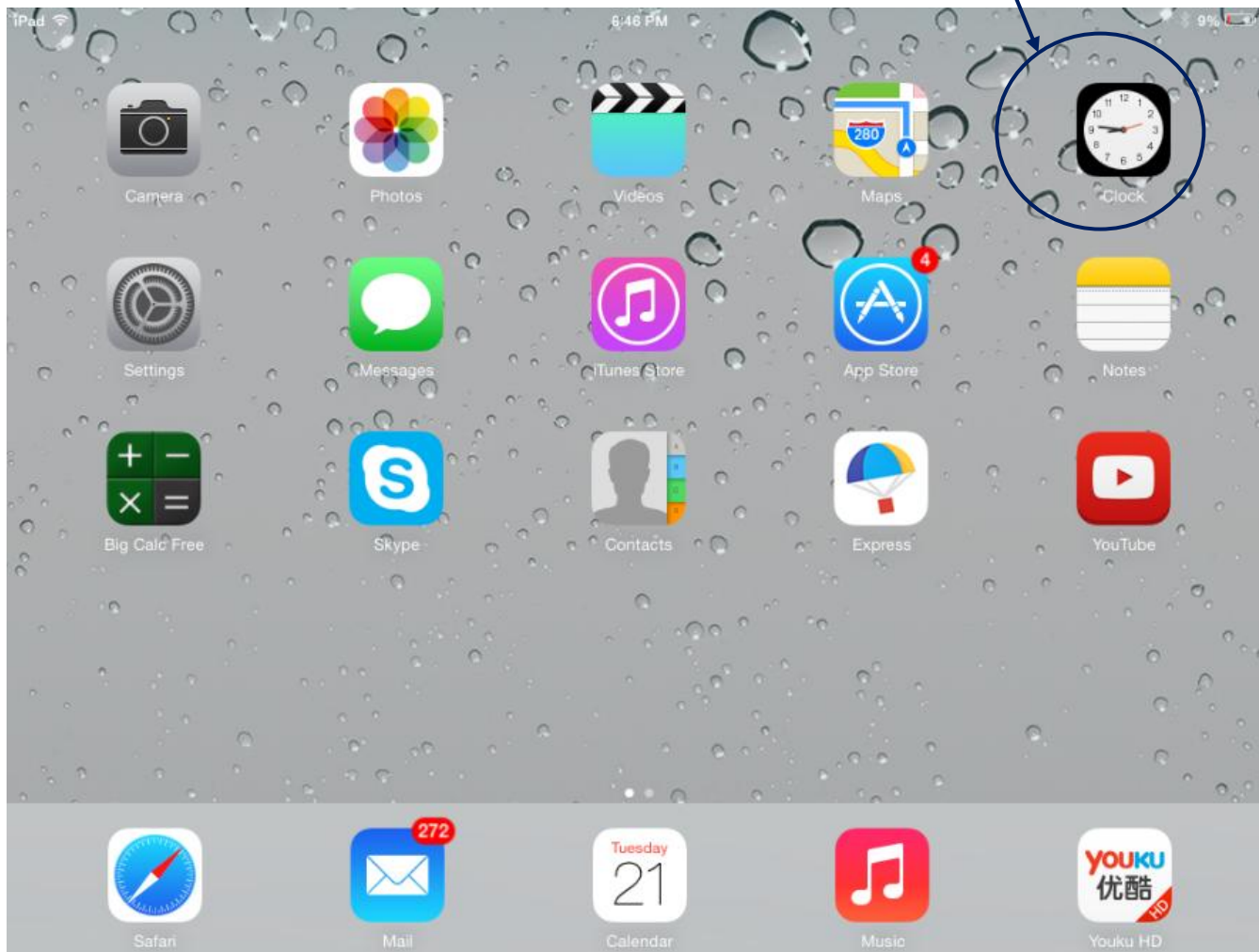
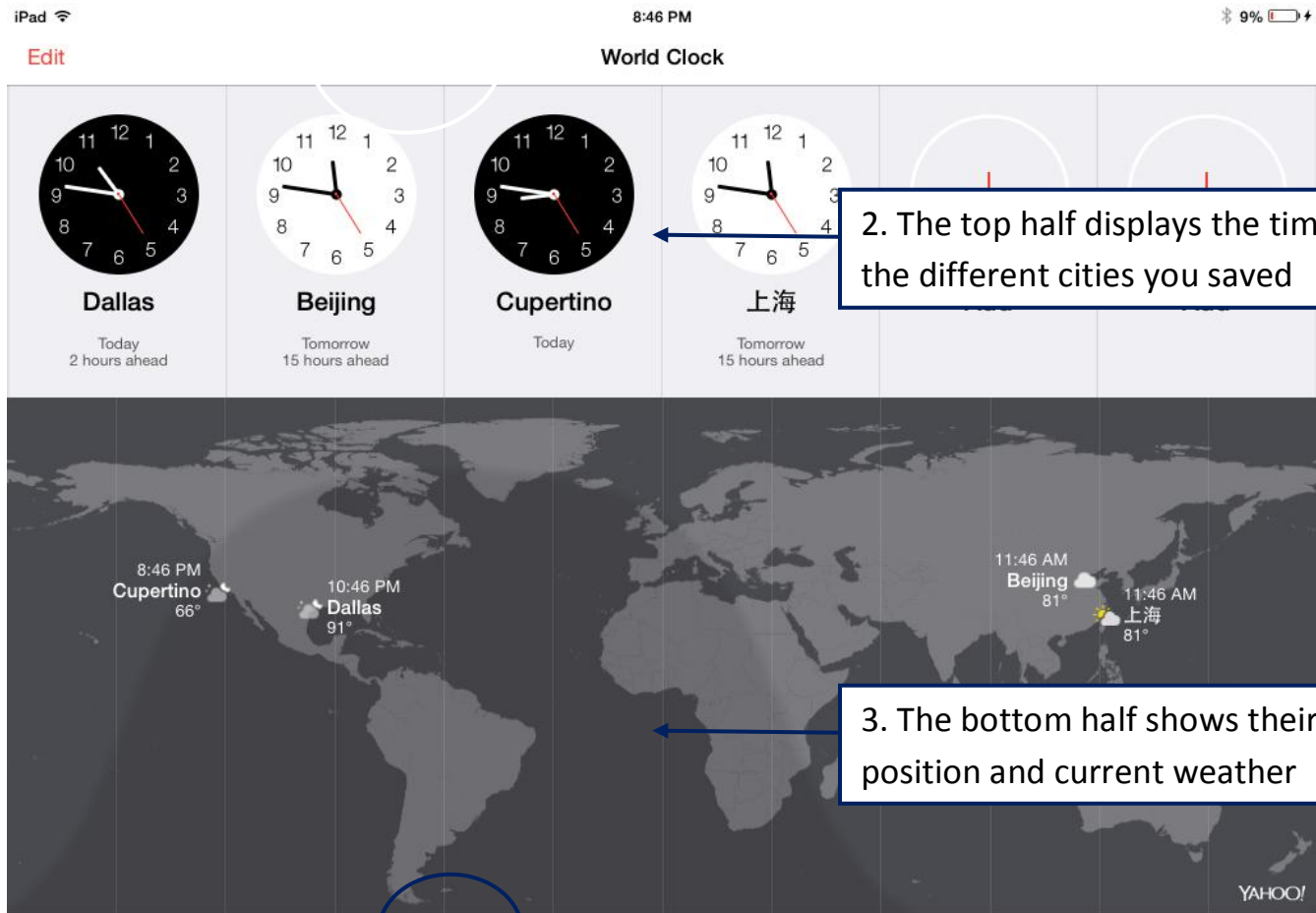

Figure 2

World Clock - Display



2. The top half displays the time for the different cities you saved

3. The bottom half shows their position and current weather

1. World Clock, the first icon at the bottom

Figure 3

World Clock – Add a City 1



Figure 4

World Clock – Add a City 2

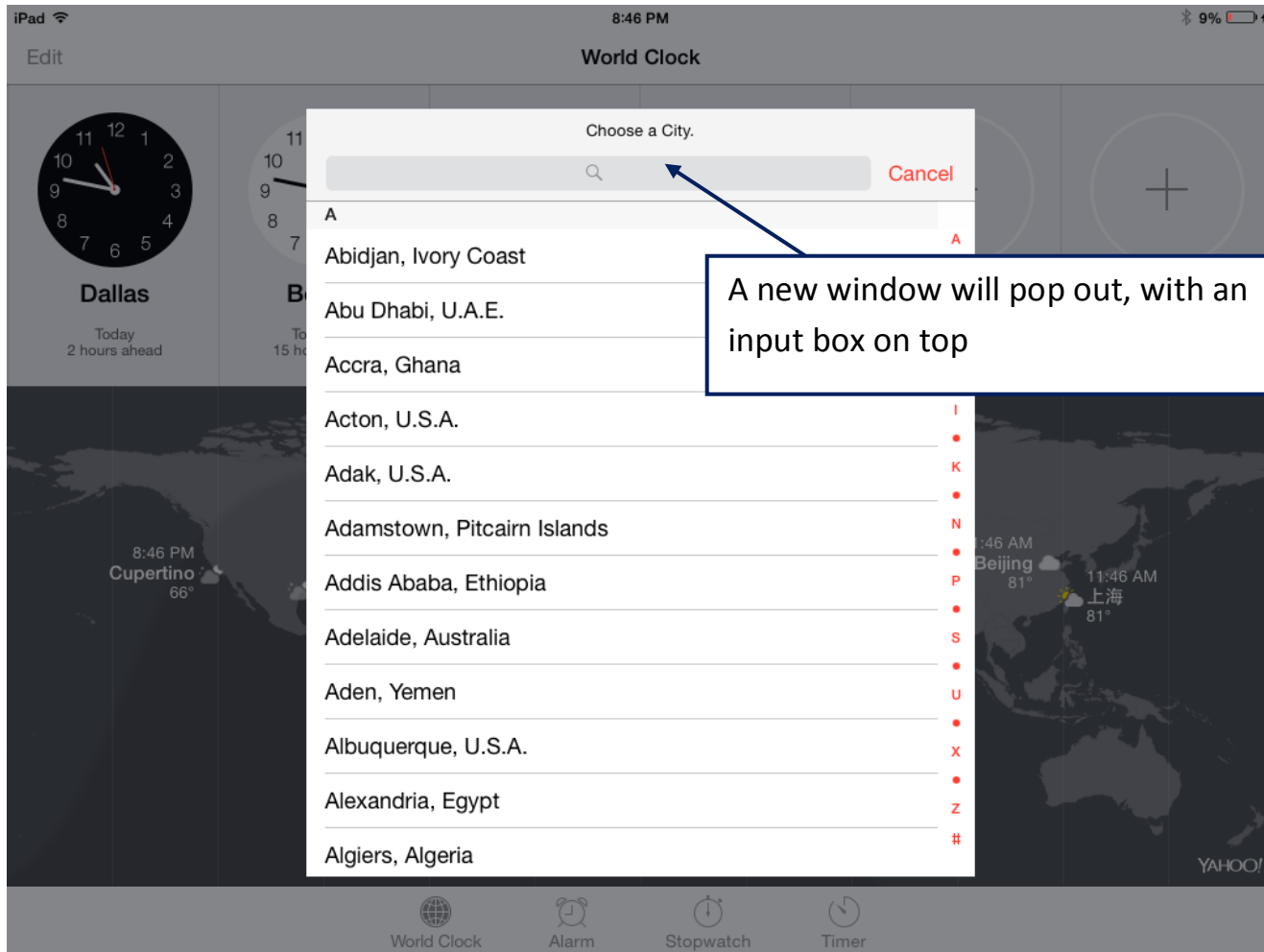

A new window will pop out, with an input box on top

Figure 5

World Clock – Add a City 3

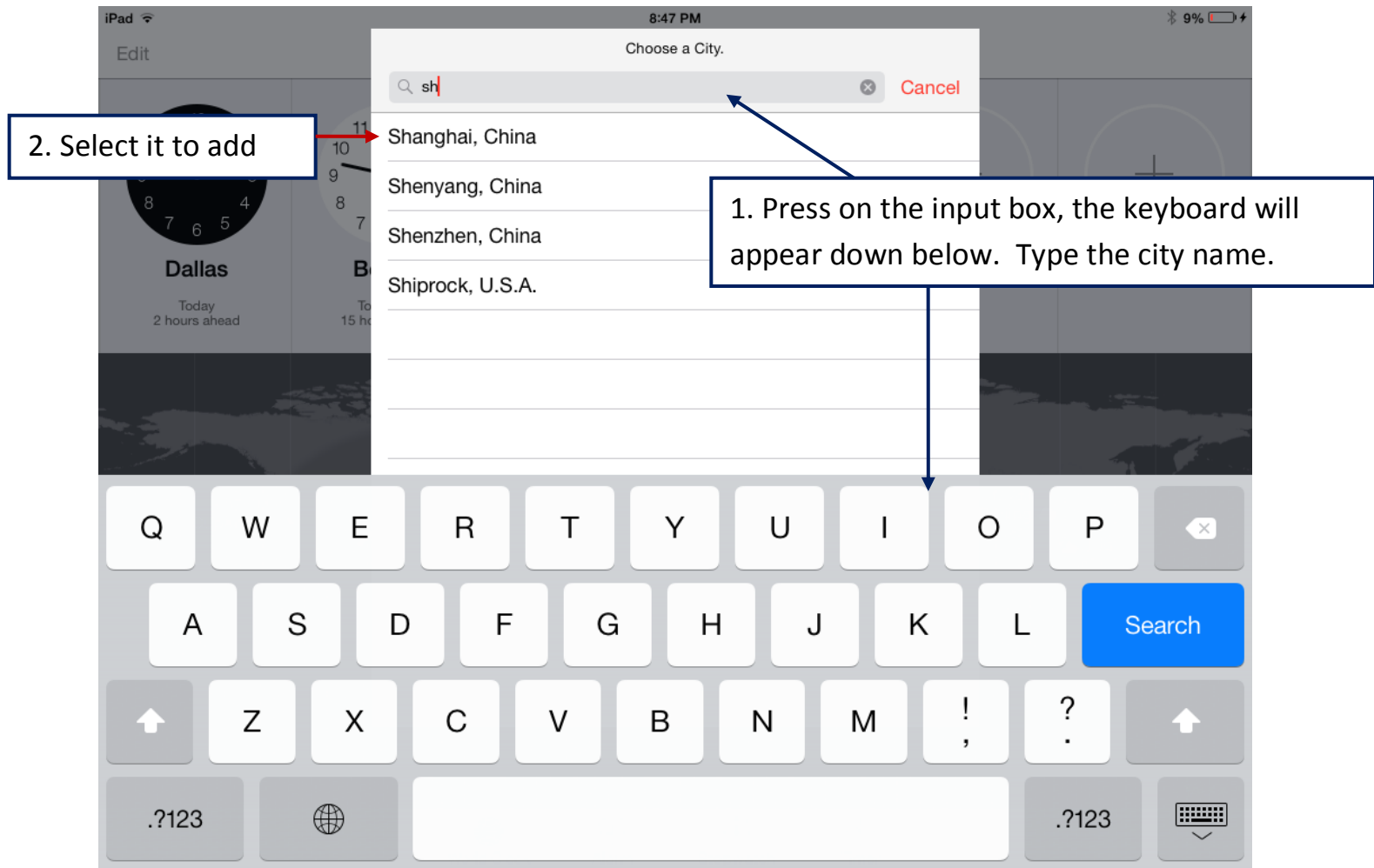

Figure 6

World Clock – Delete a City 1



To delete a city, press on the “Edit” icon, the list of city will appear.

Figure 7

World Clock – Delete a City 2

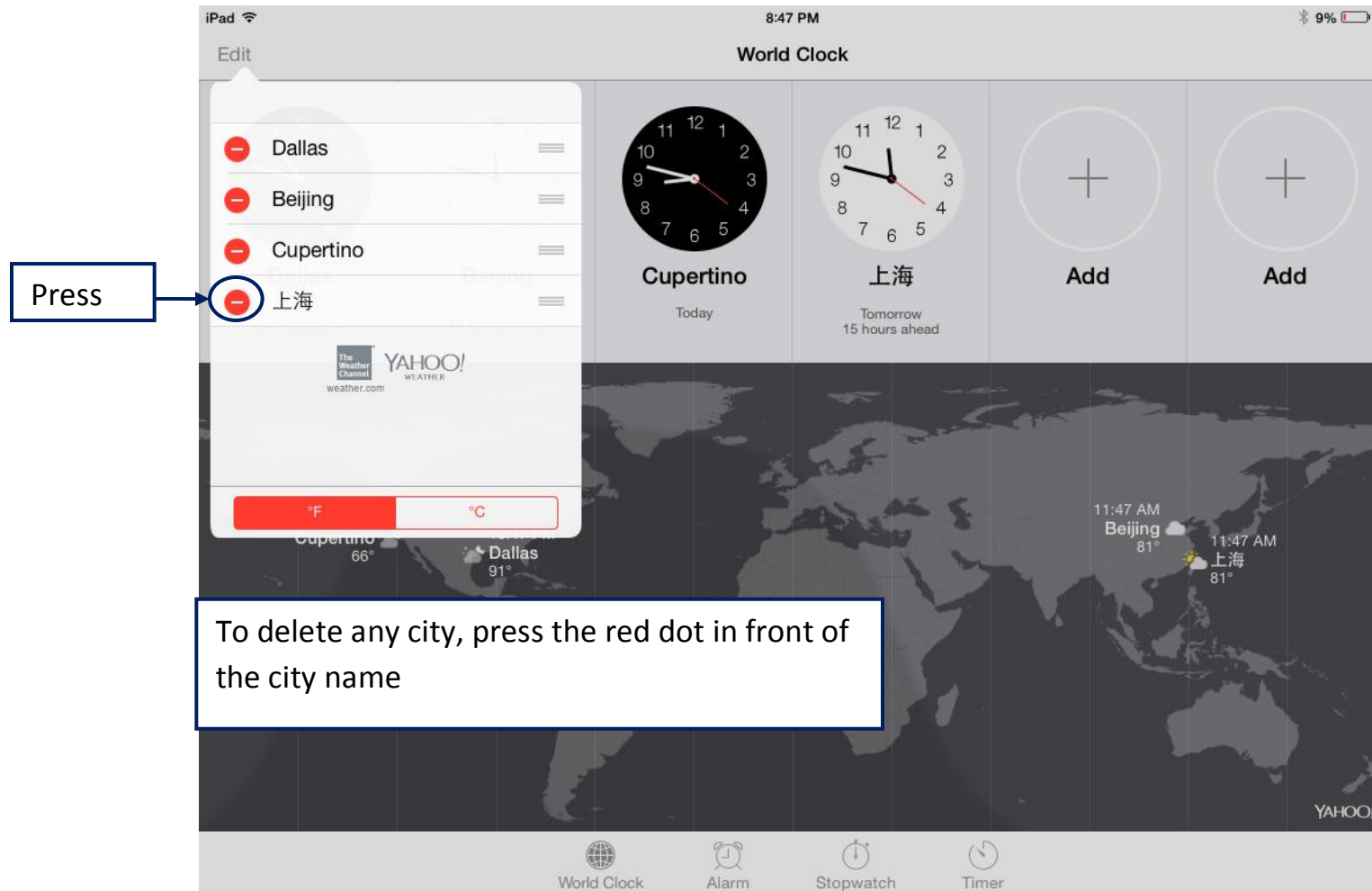
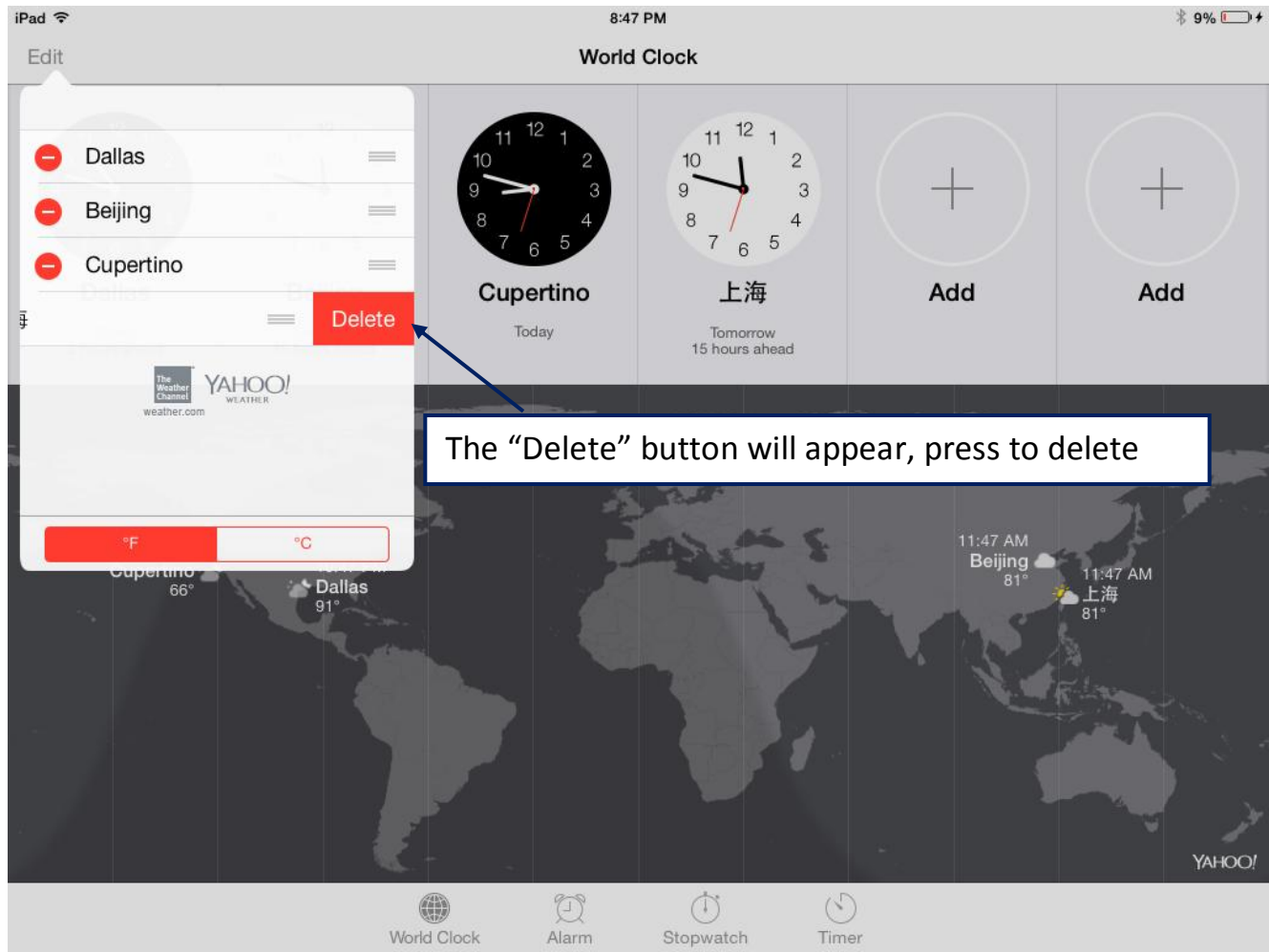

Figure 8

World Clock – Delete a City 3



The "Delete" button will appear, press to delete



Figure 9

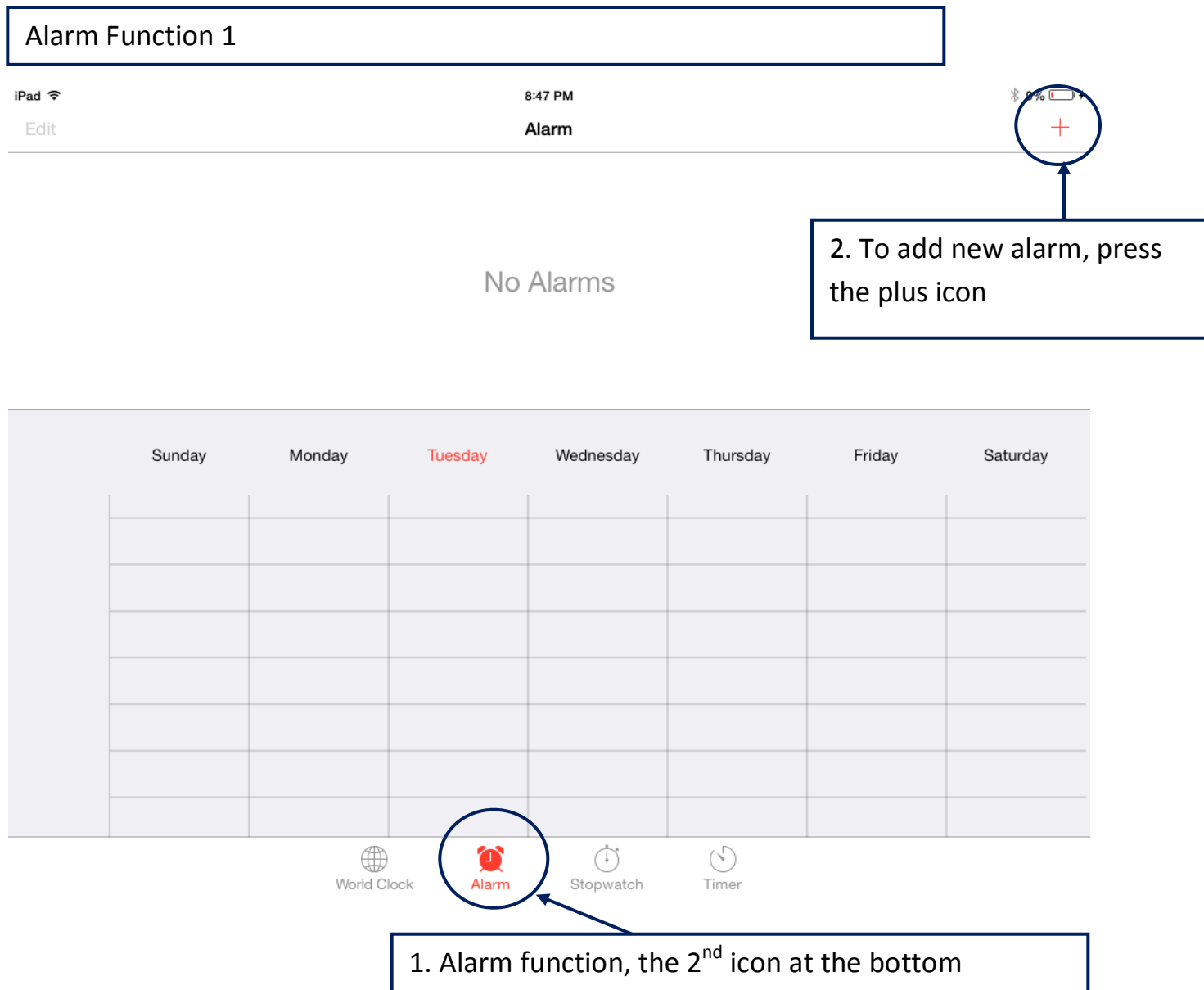

Figure 10

Alarm Function 2

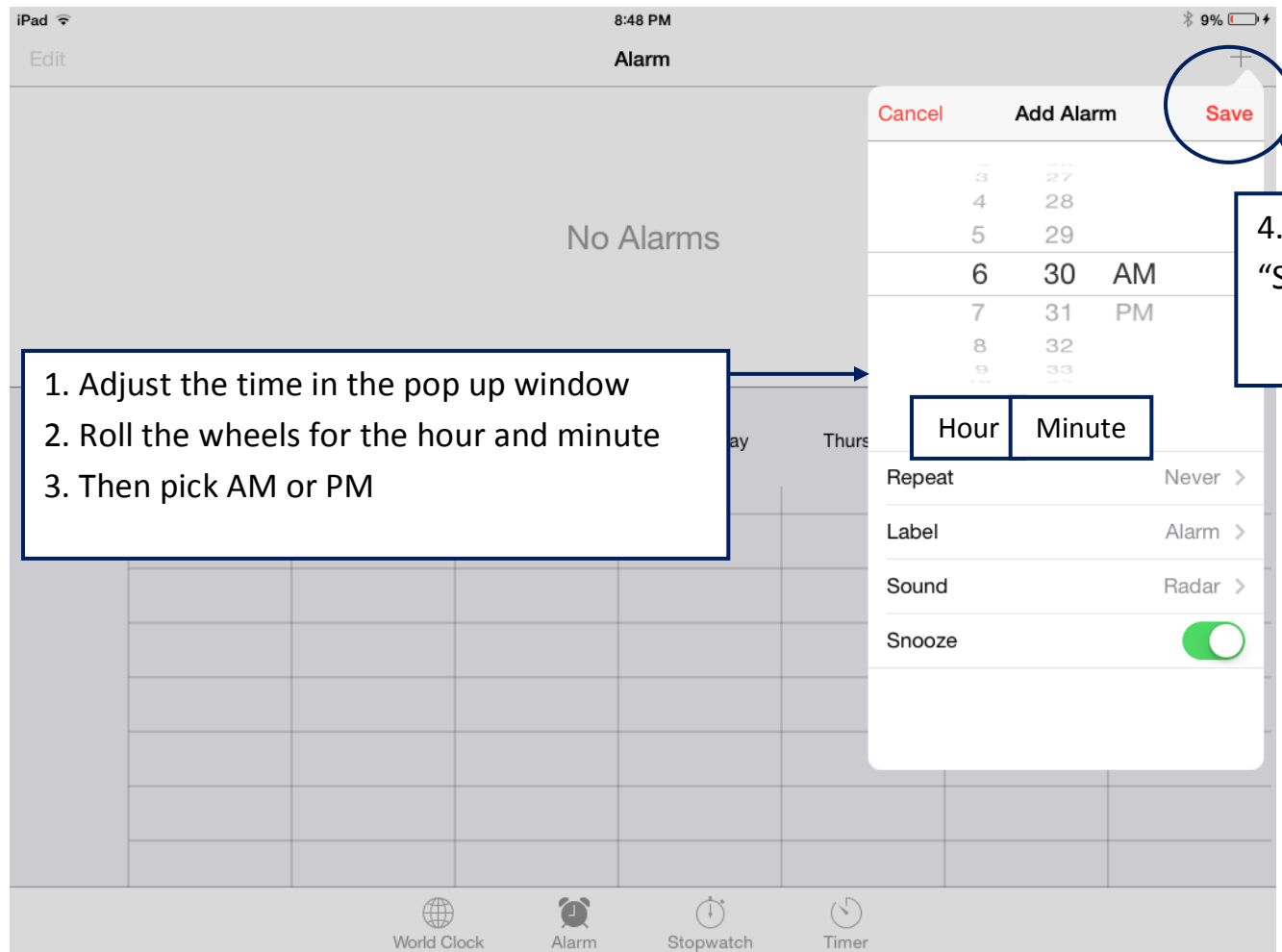

Figure 11

Alarm Function 3

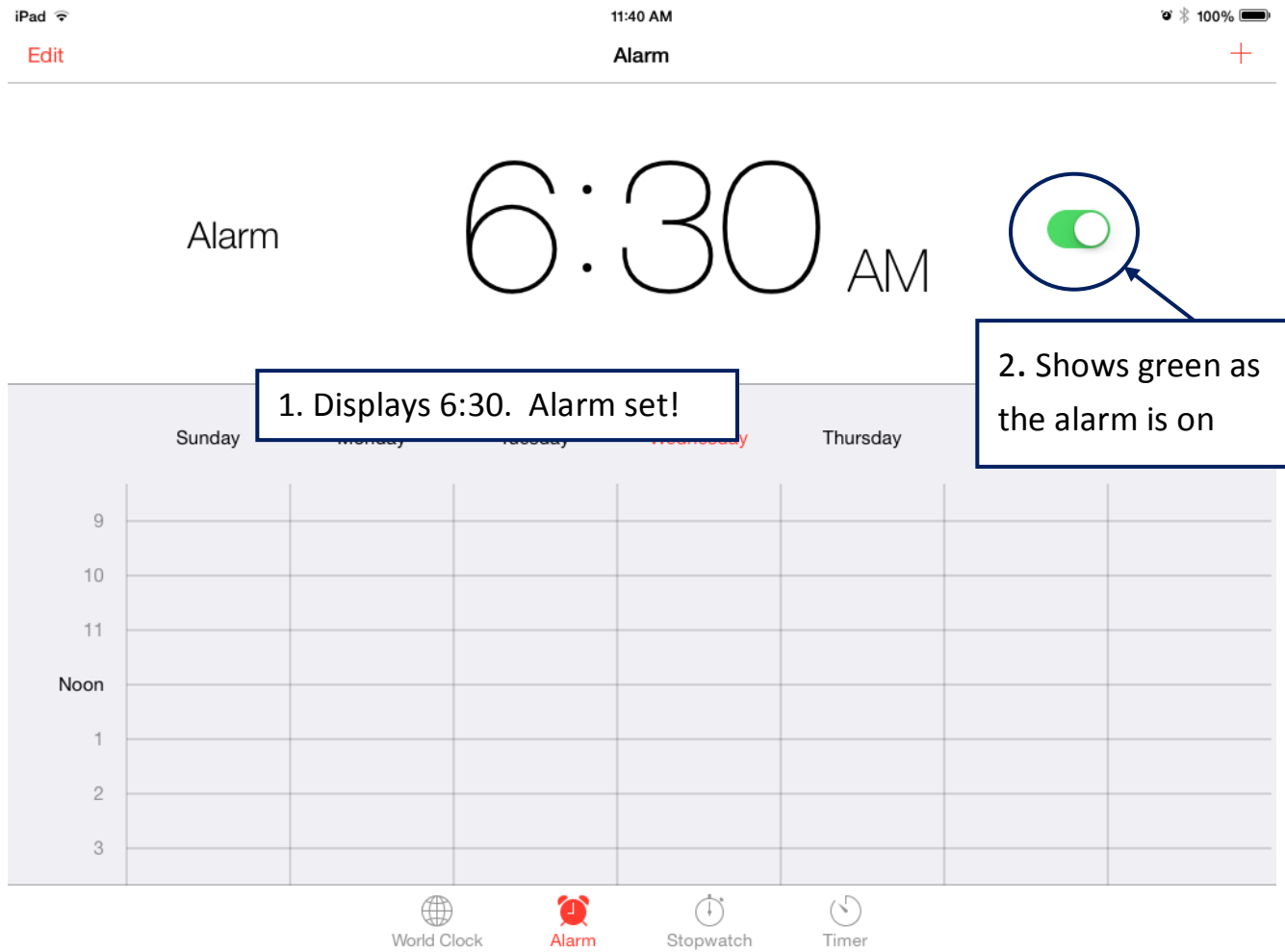

Figure 12

Alarm Function 3

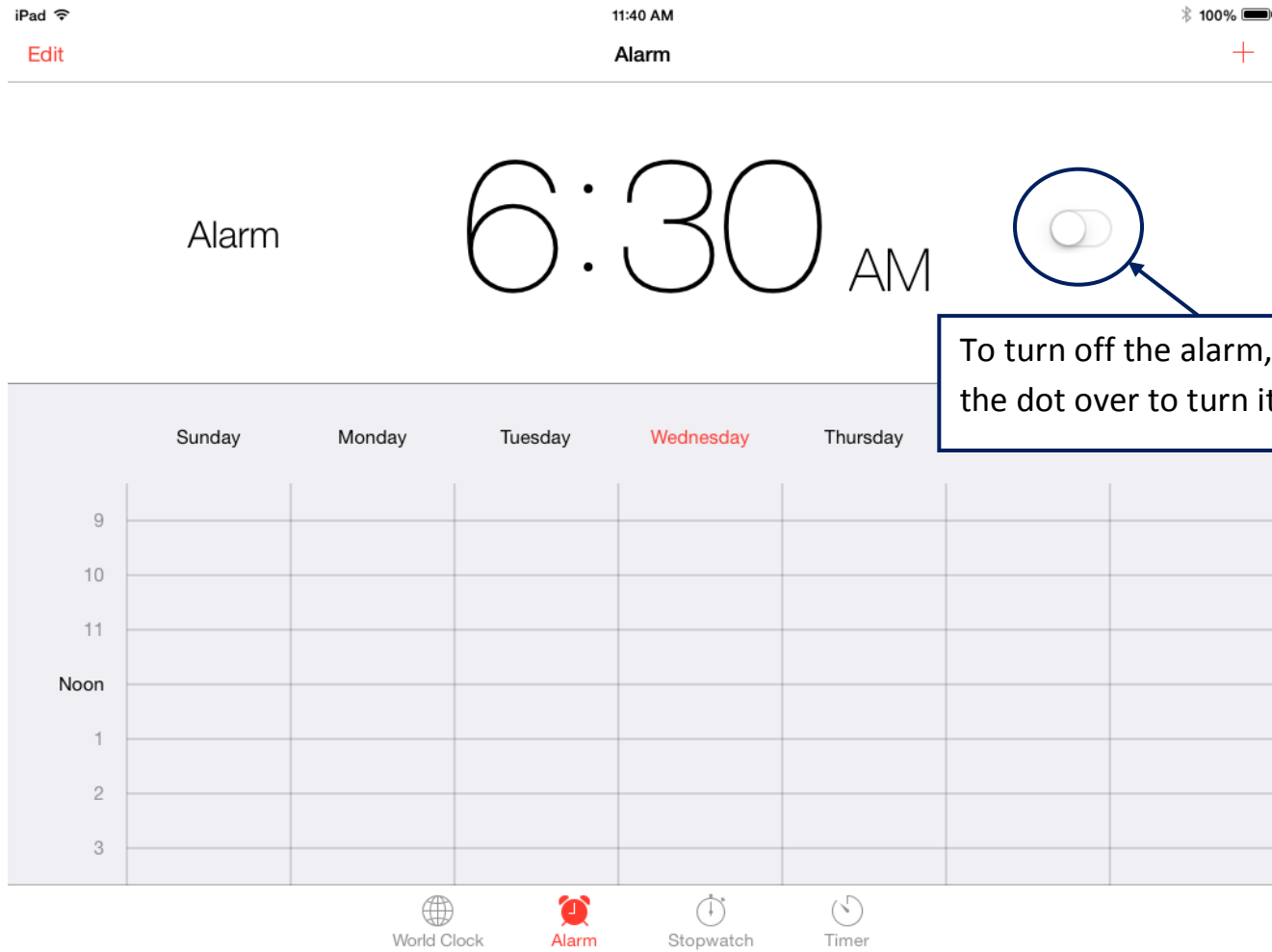

Figure 13

Timer Function 1

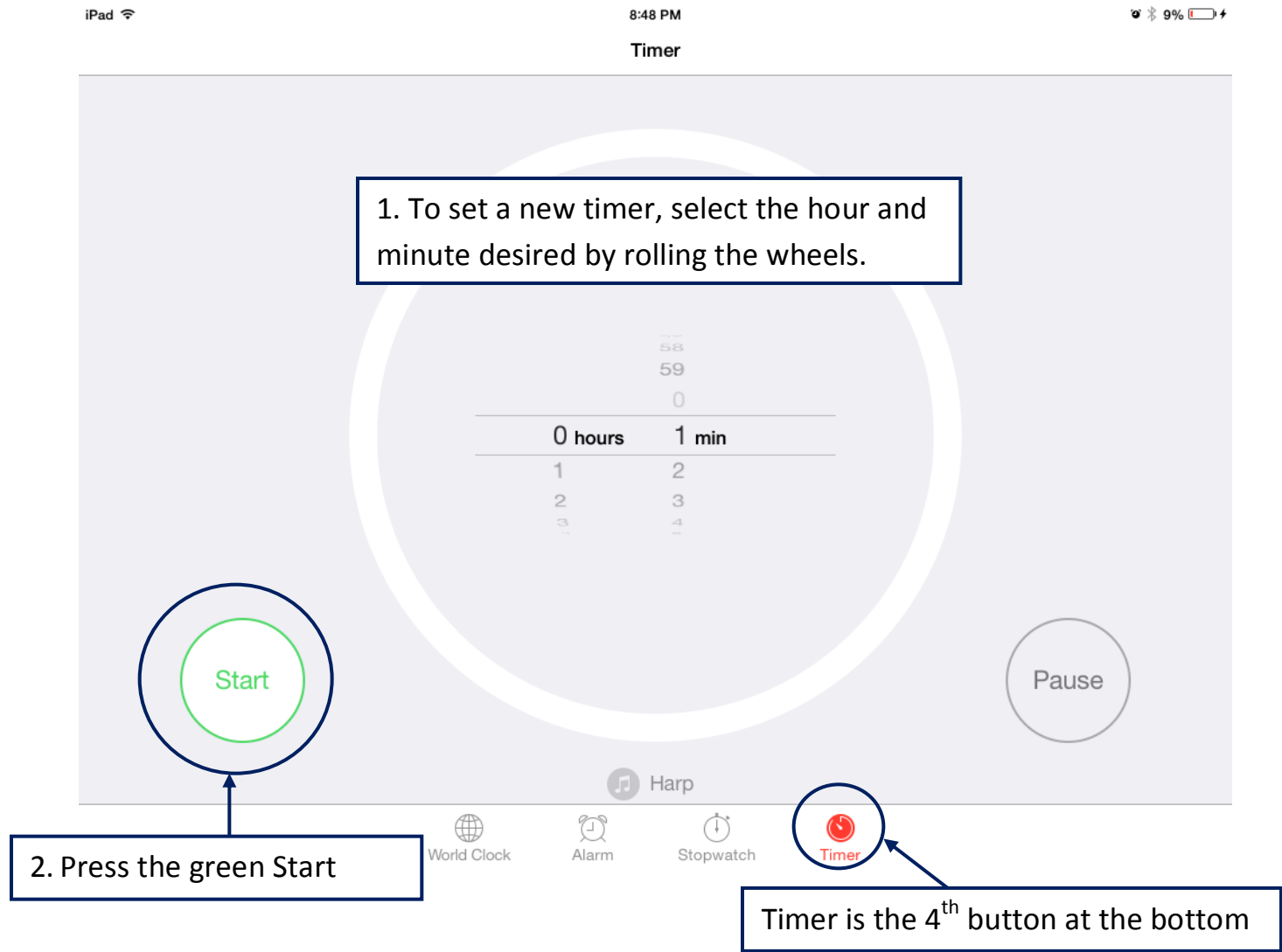

Figure 14 Timer Function 2

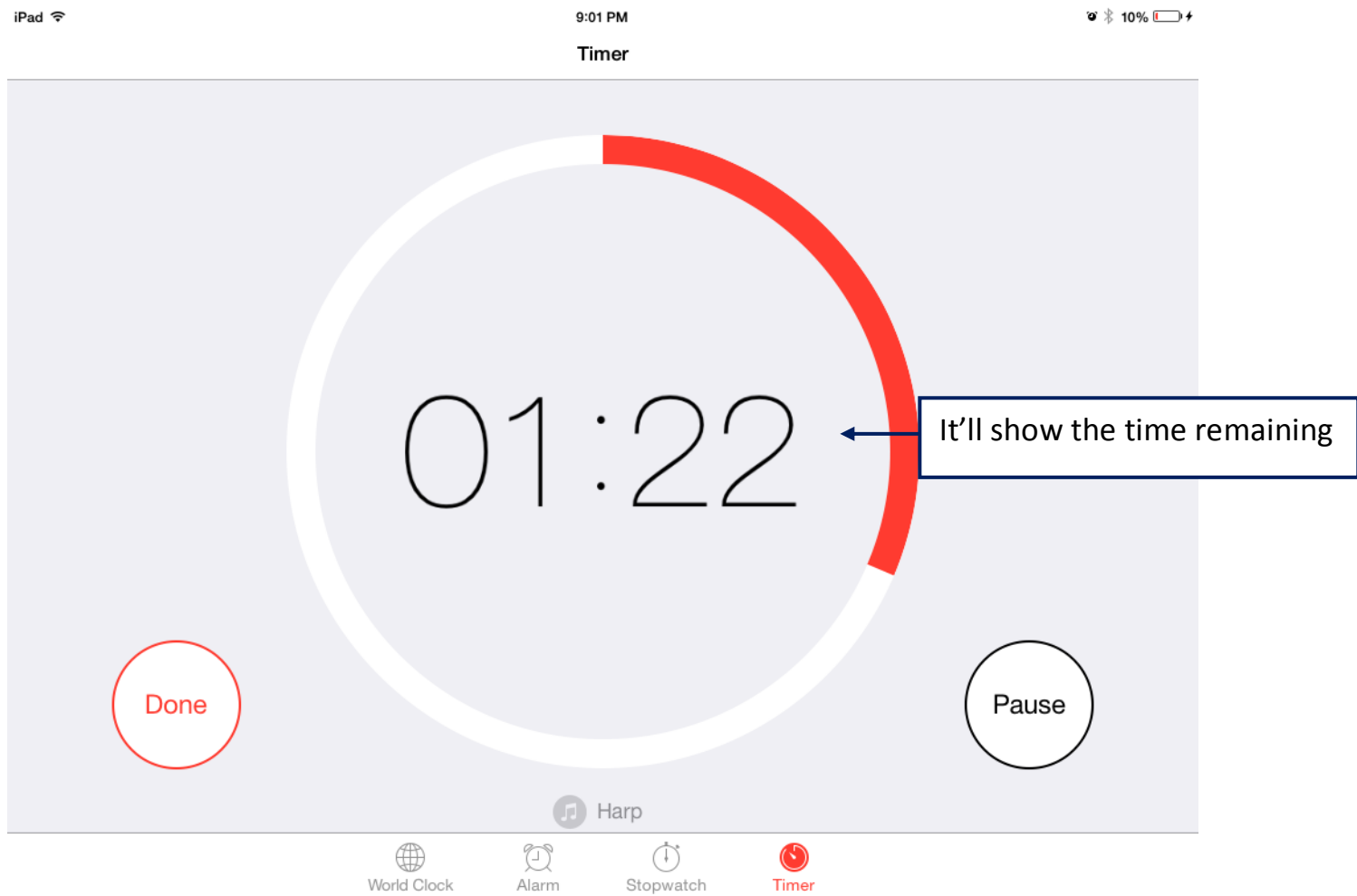
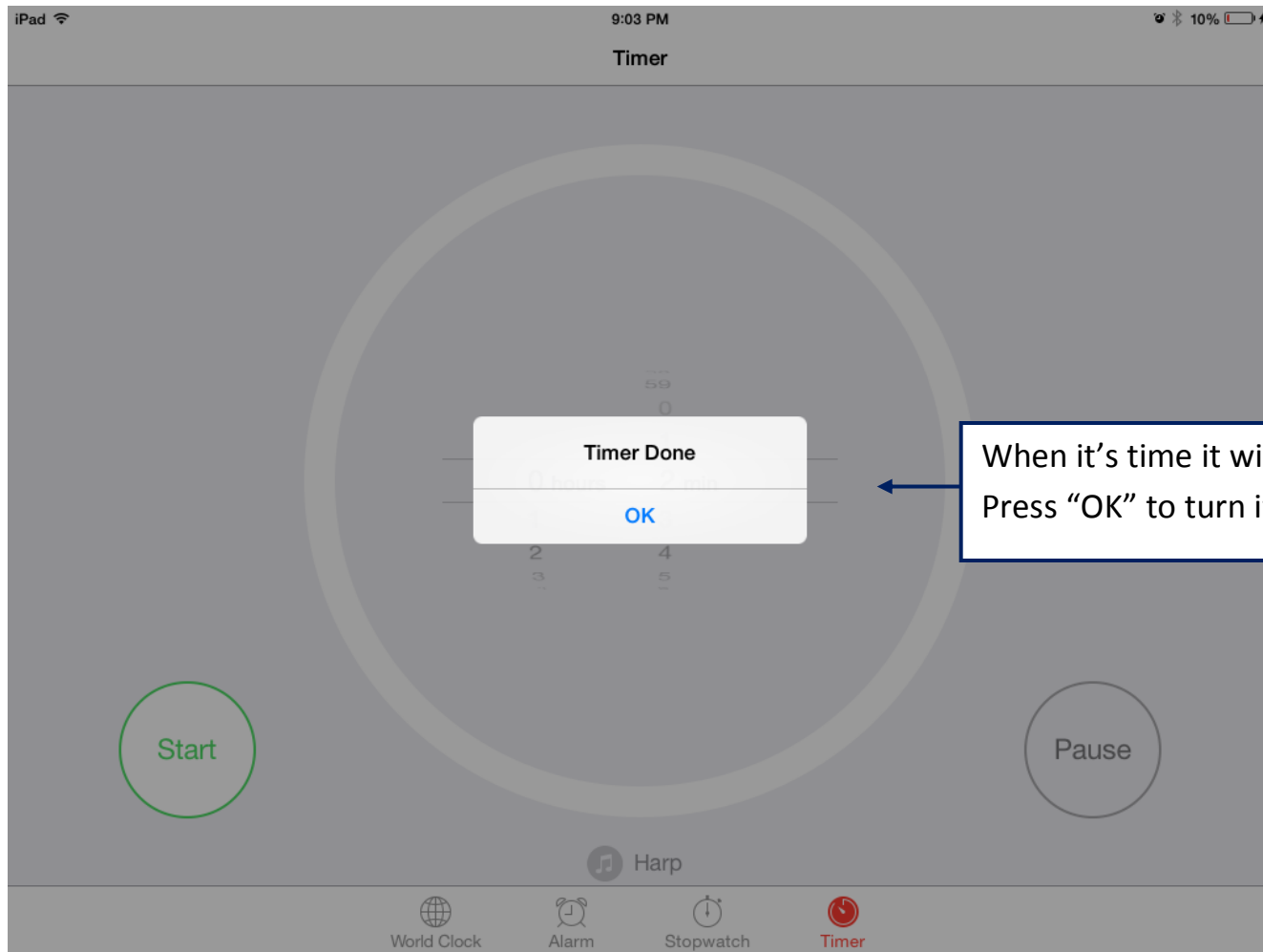

Figure 15

Timer Function 3



When it's time it will sound.  
Press "OK" to turn it off.